

Eclipse water boilers, Wall Mounted: 2W3 / 3W5 / 3W7.5 / 3W10 / 3W15
 Eclipse water boilers, Counter Top: 3C5 / 3C10
 Prices exclude packing, carriage & VAT

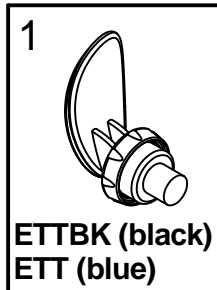

TAP TOP ASSEMBLY
 PRICE £20.80

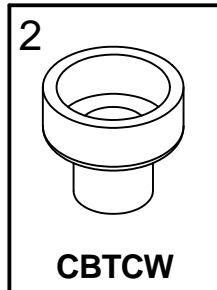

TAP CUP WASHER
 PRICE £4.80

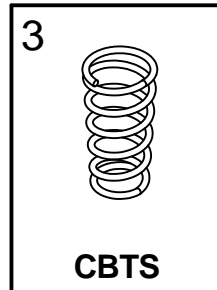

TAP SPRING
 PRICE £5.20

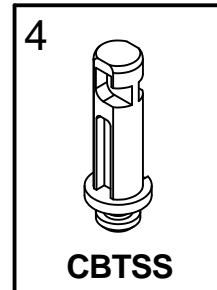

TAP SLOTTED STEM
 PRICE £2.80

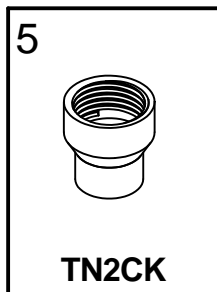

SLOW FILL NOZZLE
 PRICE £10.80



DRAW OFF TAP
 BODY
 PRICE £34.00

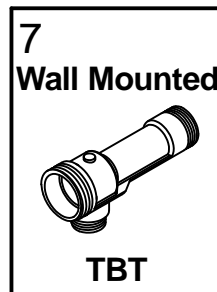

DRAW OFF TAP
 BODY
 PRICE £36.00

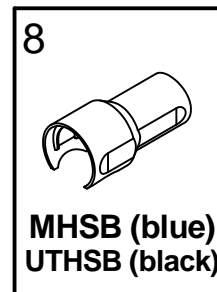

MODULAR HEAT
 SHIELD
 PRICE £9.80

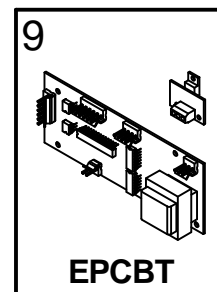

ECLIPSE P.C.B.
 TESTED
 PRICE £95.50

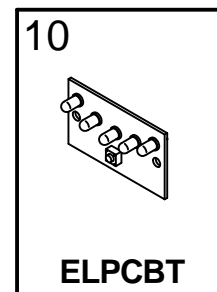

ECLIPSE LIGHT PCB
 TESTED
 PRICE £16.40

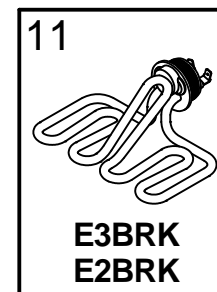

ELEMENT 3kW
 ELEMENT 2kW
 PRICE £ 48.90

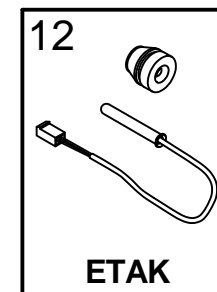

ECLIPSE THERMISTOR
 ASSEMBLY KIT
 PRICE £24.80

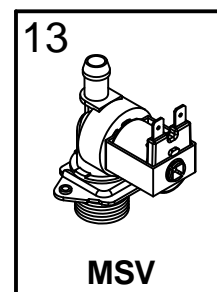

SOLENOID VALVE
 PRICE £17.40

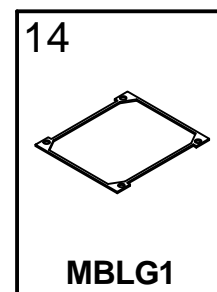

BODY LID GASKET
 FOR 3C10 MODEL
 PRICE £7.80

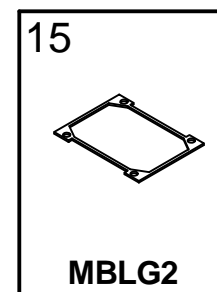

BODY LID GASKET
 FOR MODELS
 2W3, 3W5, 3C5
 PRICE £6.40

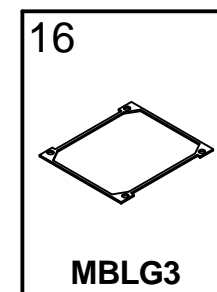

BODY LID GASKET
 FOR MODELS
 3W7.5, 3W10, 3W15
 PRICE £7.80

Eclipse water boilers, Wall Mounted: 2W3 / 3W5 / 3W7.5 / 3W10 / 3W15

Eclipse water boilers, Counter Top: 3C5 / 3C10

Prices exclude packing, carriage & VAT

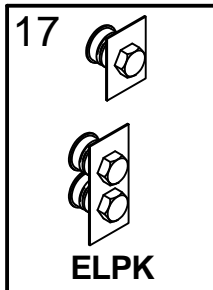

ECLIPSE LEVEL
PROBES KIT
PRICE £29.80

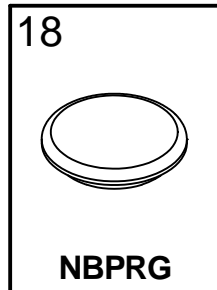

BODY LID GROMMET
PRICE £2.90

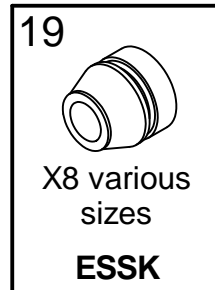

ECLIPSE SILICONE
SEAL KIT
PRICE £18.00

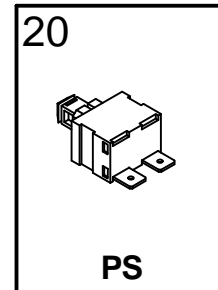

POWER SWITCH
PRICE £3.20

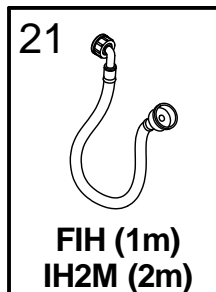

WATER INLET HOSE
HOSE (FIH)
PRICE £10.60
HOSE (IH2M)
PRICE £17.00